

### 扁线大电流磁珠

Ferrite Bead (Flat Wire High Current)



#### 特性

Characteristics

稳定特征

Stable characteristic

适用于高电流应用

Suitable for applications with high currents

工作温度: -55°C至+125°C

Operating temperature: -55 °C to +125 °C

#### 应用

Application

高负载电流的电压源

Voltage supply for high load current

电源应用

Power Supply Application

电脑、电视卡

PC, TV Card

#### 产品品名介绍

Product Number Structure

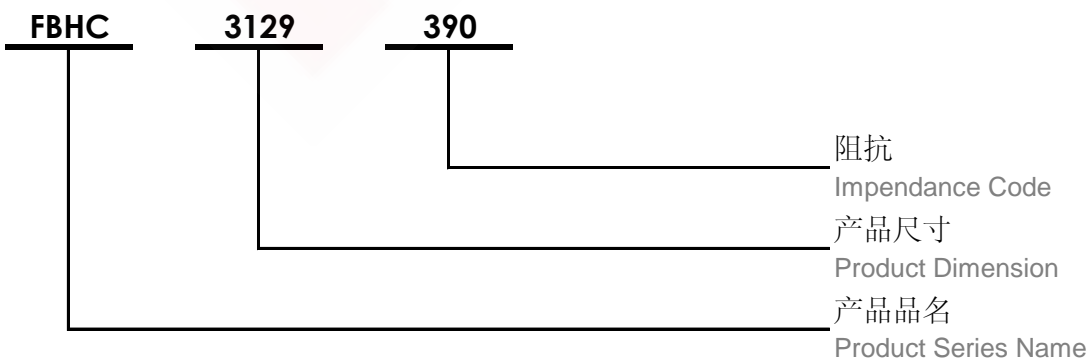



### 尺寸

Dimension (mm)

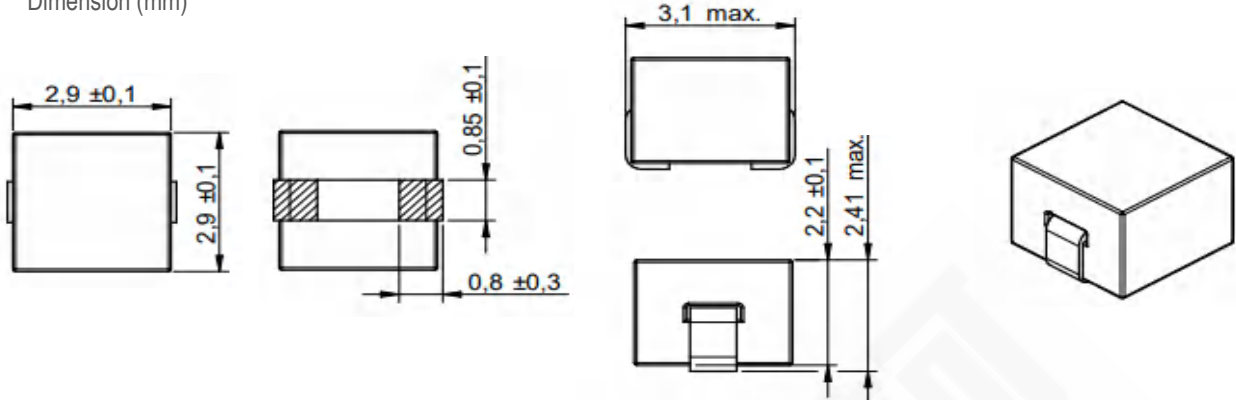

### 焊盘推荐

Land Pattern Recommended (mm)

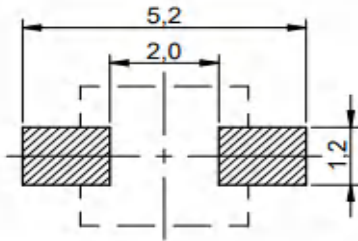

### 示意图

Schematics



### 电性特性

Electrical Properties

型号 Part No.	阻抗 Impedance Z (Ω)	温升电流 Rated Current I <sub>R</sub> 40°C (A)	直流电阻 DCResistance DCR <sub>max</sub> (Ω)	卷盘数量 Taping Reel Qty. pcs
FBHC3129-390	39 ±25%	14.00	0.60	4,000

### 测试状态

Test Condition

- ☆ 阻抗测试条件为 100MHz (25°C)  
Impedance measure condition at 100MHz (25°C)
- ☆ 工作温度: -55°C ~ +125°C  
Operating Temperature: -55°C ~ +125°C



### 尺寸

Dimension (mm)

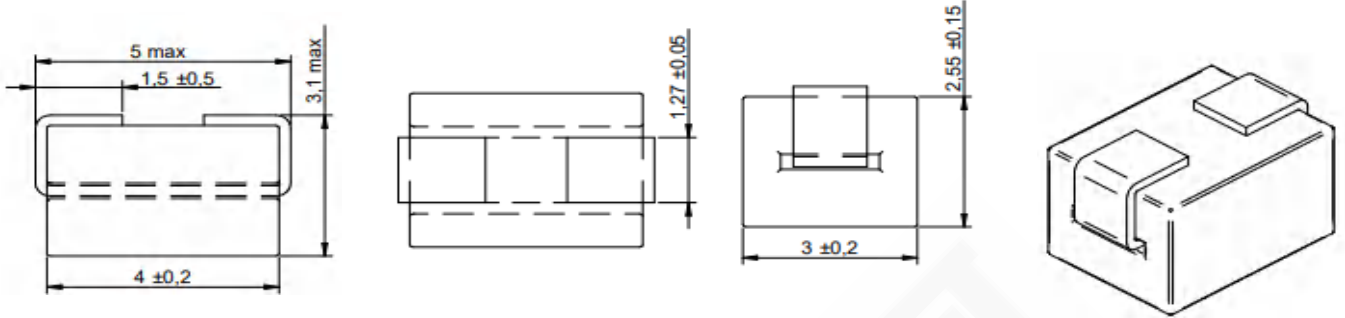

### 焊盘推荐

Land Pattern Recommended (mm)

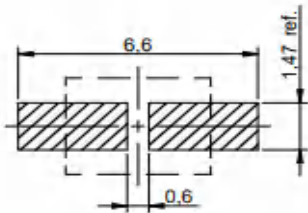

### 示意图

Schematics



### 电性特性

Electrical Properties

型号 Part No.	阻抗 Impedance Z (Ω)	温升电流 Rated Current I <sub>R</sub> 40°C (A)	直流电阻 DC Resistance DCR <sub>max</sub> (Ω)	卷盘数量 Taping Reel Qty. pcs
FBHC5030-420	42 ±25%	16.00	0.60	500

### 测试状态

Test Condition

- ☆ 阻抗测试条件为 100MHz (25°C)  
Impedance measure condition at 100MHz (25°C)
- ☆ 工作温度: -55°C ~ +125°C  
Operating Temperature: -55°C ~ +125°C



### 尺寸

Dimension (mm)

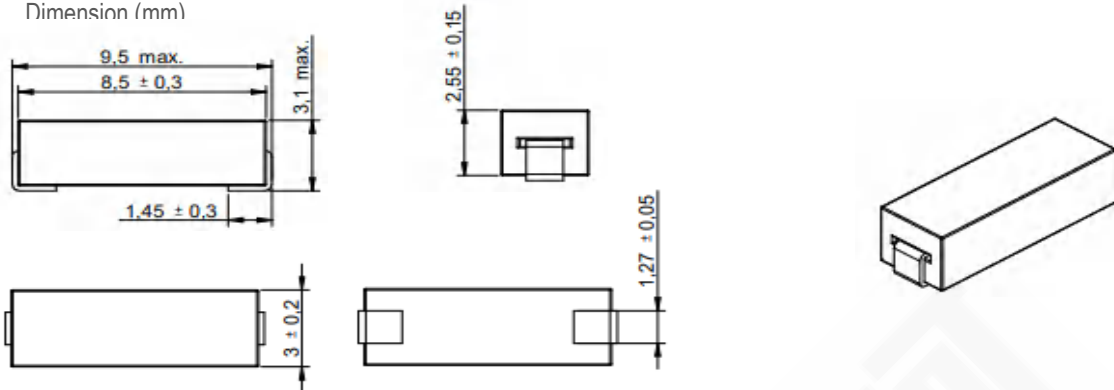

### 焊盘推荐

Land Pattern Recommended (mm)

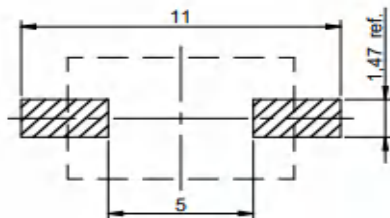

### 示意图

Schematics



### 电性特性

Electrical Properties

型号 Part No.	阻抗 Impedance Z (Ω)	温升电流 Rated Current I <sub>R</sub> 40°C (A)	直流电阻 DC Resistance DCR <sub>max</sub> (Ω)	卷盘数量 Taping Reel Qty. pcs
FBHC9530-910	91 ±25%	17.00	0.90	500

### 测试状态

Test Condition

- ☆ 阻抗测试条件为 100MHz (25°C)  
Impedance measure condition at 100MHz (25°C)
- ☆ 工作温度: -55°C ~ +125°C  
Operating Temperature: -55°C ~ +125°C



### 尺寸

Dimension (mm)

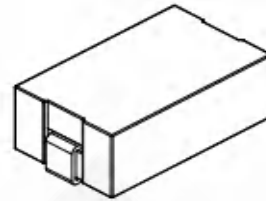
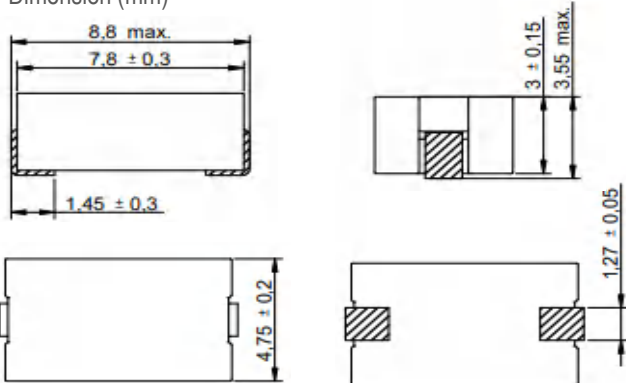

### 焊盘推荐

Land Pattern Recommended (mm)

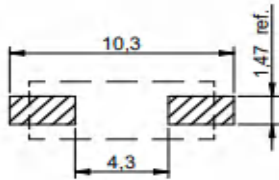

### 示意图

Schematics



### 电性特性

Electrical Properties

型号 Part No.	阻抗 Impedance Z (Ω)	温升电流 Rated Current I <sub>R</sub> 40°C (A)	直流电阻 DC Resistance DCR <sub>max</sub> (Ω)	卷盘数量 Taping Reel Qty. pcs
FBHC8847-980	98 ±25%	18.00	0.90	500

### 测试状态

Test Condition

- ☆ 阻抗测试条件为 100MHz (25°C)  
Impedance measure condition at 100MHz (25°C)
- ☆ 工作温度: -55°C ~ +125°C  
Operating Temperature: -55°C ~ +125°C



### 典型阻抗特性

Typical Impedance Characteristics

#### FBHC3129-390

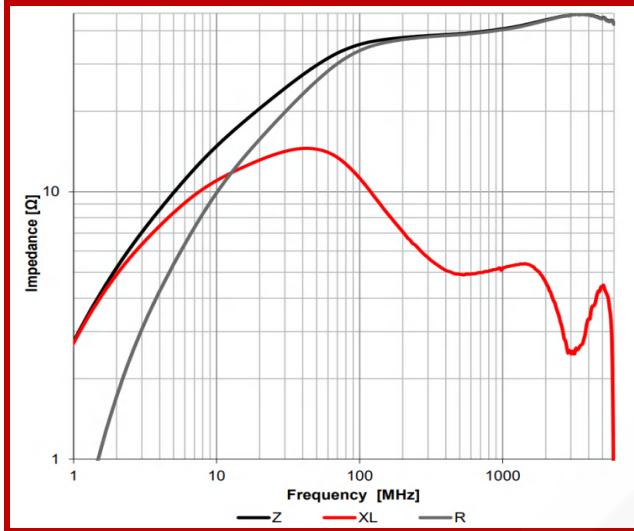

#### FBHC5030-420

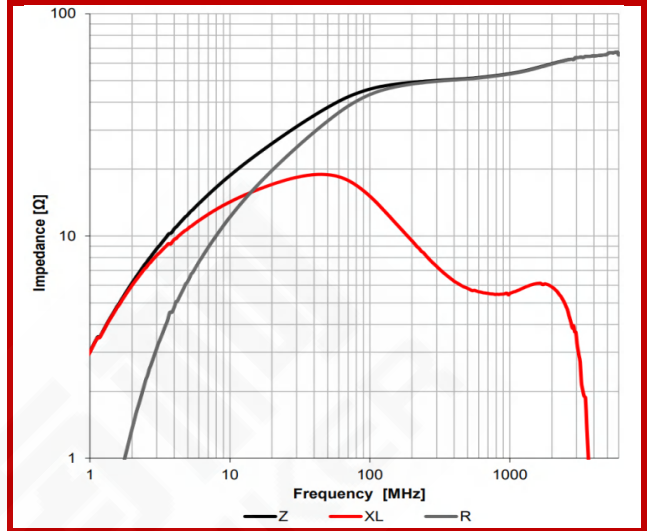

#### FBHC9530-910

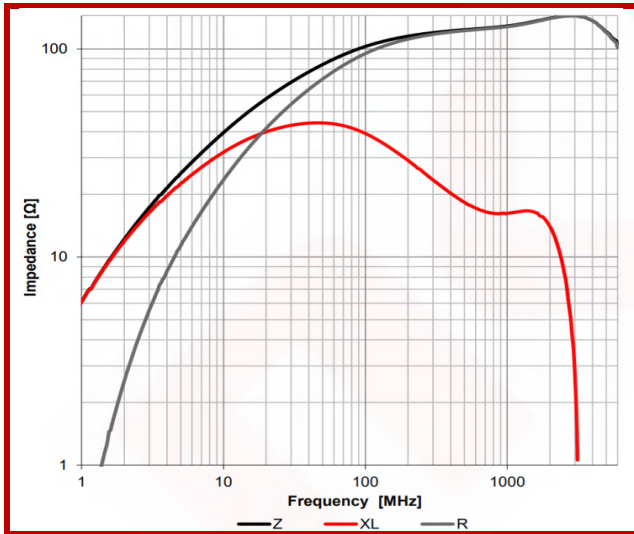

#### FBHC8847-980

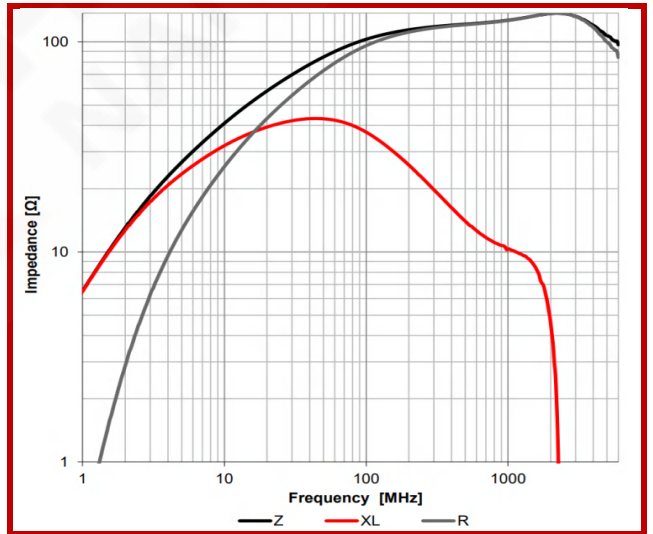



### 回流焊曲线图

Classification Reflow Profile for SMT Components

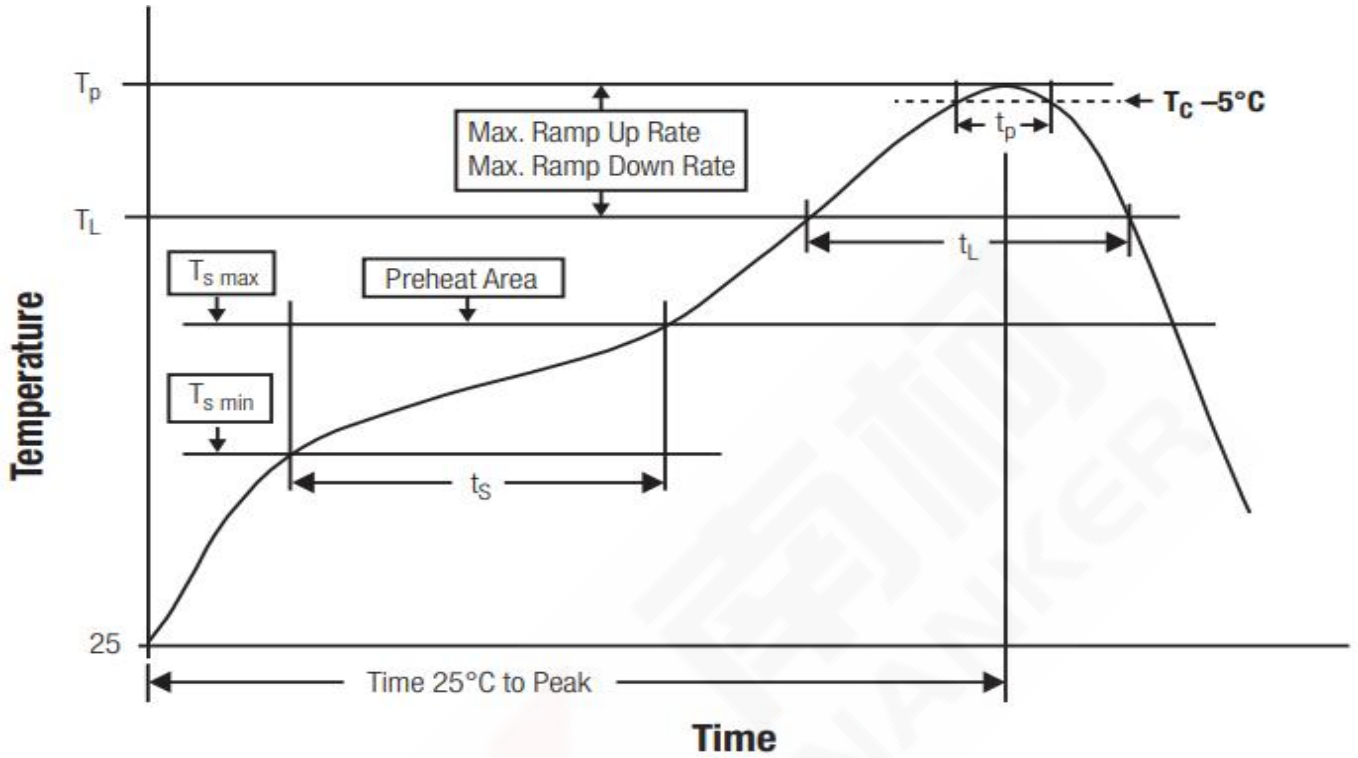

### 封装体峰值温度(Tp)分类

Classification Reflow Soldering Profile:

	封装厚度 Package Thickness	封装体积 Package Volume		
		<350 mm <sup>3</sup>	350~2,000 mm <sup>3</sup>	>2,000 mm <sup>3</sup>
无铅装配 PB-Free Assembly	<1.60mm	260°C	260°C	260°C
	1.60~2.50mm	260°C	250°C	245°C
	>2.50mm	260°C	245°C	245°C

- ◆ 回流焊参照标准 IPC/JEDEC J-STD-020D。  
Reflow is refer to standard IPC/JEDEC J-STD-020D.